

A/23/TE-1 Piezoelectric Accelerometer

Integral ceramic isolating base

8pC/g nom. 3.6gm 200°C Max. temp



A generic range of lightweight, Konic shear® sensing element based vibration transducers offering a choice of tapped base stud mount or flat based adhesive attachment and each with side or top mounted connector. All welded construction maximizes temperature range and reliability.

Adhesive mounted versions - Abrasive cleaning of the attachment face will reduce base thickness over time; sparing use of adhesive will aid longevity, whilst also maximizing data accuracy.

Applications:

- Modal, analysis
- High level vibration to 5000g.
- Shock to 10,000g.
- High level measurements, top entry connector versions, minimising case loading, are preferred.

Options:

- A/23/E – Side entry
- A/23/EB – Side entry, tapped base
- A/23/TE – Top entry
- A/23/TB – Top entry, tapped base
- A/23/E-1 – Side entry, isolated base
- A/23/TE-1 – Top entry, isolated base

Typical Frequency Response

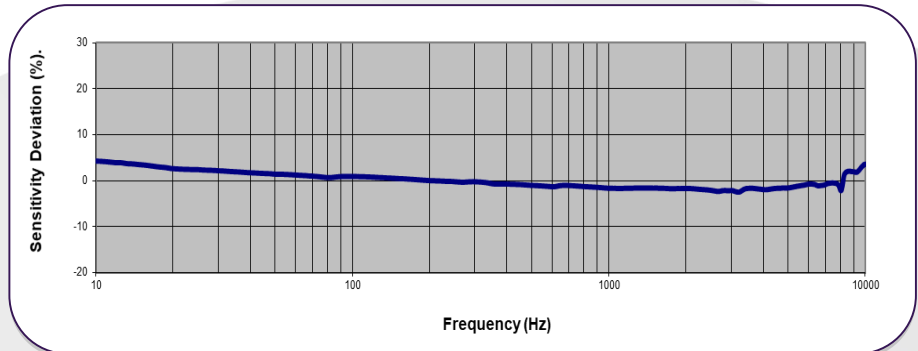

	Metric	Imperial
Charge sensitivity nom.	0.81pC/(m/s ²)	8pC/g
Resonant Frequency	≥50 kHz	
Typical Frequency Response	±5% ±10%	1Hz – 10kHz 0.7Hz – 11kHz
Cross Axis error	≤5%	
Capacitance nom.	1050 pF	
Temperature Range	-55/ +200°C	-67/ +392°F
Charge sensitivity deviation (20°C/68°F)	-5% @ -55°C +10% @ +200°C	-5% @ -67°F +10% @ +392°F
Base Strain Sensitivity	≤0.001g/μ strain	
Maximum Shock g level, rise time μs	98100m/s ² , 30	10000g, 30
Pyro-electric output	0.15g/°C	
Pyro-electric corner frequency	0.005Hz	
Case Material	Titanium Grade 2	
Mounting	Adhesive integral isolating base	
Weight	3.6g	0.12oz
Case seal	Welded	
Size	9.5 (A/F) x 12.5mm	0.375 (A/F) x 0.49in
Connector	Top entry 10-32 UNF Microdot	

Temperature Response

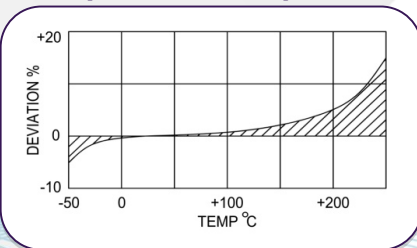

A/23/TE

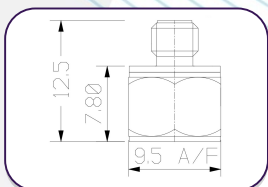

Please note: For information and reference only. Data should not be used as pass / fail criteria for calibration purposes.

DJB Instruments (UK) Ltd

Finchley Avenue,
Mildenhall, Suffolk IP28 7BG

Tel +44 (0)1638 712 288
Email sales@djbinstruments.com
Web www.djbinstruments.com

DJB Iss.1 2020

A UK company with UK-based manufacturing, assembly and calibration in-house.



ISO 9001 – 00025363